

SITE PLAN FOR PROPOSED G+4 STORIED RESIDENTIAL CUM COMMERCIAL BUILDING OF THE CHAIRMAN OF BHADRESWAR MUNICIPALITY " BIBHUTI ABASON" AT HOLDING NO.- 23/A , SITUATED AT R.B. AVENUE BHADRESWAR STATION ROAD ; WARD NO. - 20 ; L.R. DAG NO. - 1000 ; L.R. KHATIAN NO.- 1298 & 1633 ; J.L. NO. - 12 ; MOUZA:- BHADRESWAR ; P.S.-BHADRESWAR ; UNDER BHADRESWAR MUNICIPALITY ; DISTRICT.- HOOGHLY. WEST BENGAL.

**AREA OF LAND = 13 KA. 09 CH. 36 SQ.FT. OR. 910.87 SQ.MT.
 PROPOSED LAND AREA = 349 SQ.MT.**

A) PROPOSED BUILT UP AREA :

- 1) PROPOSED GROUND FLOOR SUPER BUILT UP AREA = 3068 SQ.FT. OR. 285.17 SQ.MT.
- 2) PROPOSED FIRST FLOOR SUPER BUILT UP AREA = 3068 SQ.FT. OR. 285.17 SQ.MT.
- 3) PROPOSED SECOND FLOOR SUPER BUILT UP AREA = 3068 SQ.FT. OR. 285.17 SQ.MT.
- 4) PROPOSED THIRD FLOOR SUPER BUILT UP AREA = 3068 SQ.FT. OR. 285.17 SQ.MT.
- 5) PROPOSED FOURTH FLOOR SUPER BUILT UP AREA = 3068 SQ.FT. OR. 285.17 SQ.MT.
- 6) TOTAL PROPOSED SUPER BUILT UP AREA = 15340 SQ.FT. OR. 1425.85 SQ.MT.

A) PROPOSED CARPET AREA :

- 1) PROPOSED GROUND FLOOR COMMERCIAL CARPET AREA = 147.53 SQ.MT.
- 2) EACH FLAT CARPET AREA :- A = 39.47 SQ.MT. ; B = 58.84 SQ.MT. ; C = 58.33 SQ.MT. ; D = 50.49 SQ.MT. ;
- 3) PROPOSED FIRST FLOOR CARPET AREA = 207.13 SQ.MT.
- 3) PROPOSED SECOND FLOOR CARPET AREA = 207.13 SQ.MT.
- 4) PROPOSED THIRD FLOOR CARPET AREA = 207.13 SQ.MT.
- 5) PROPOSED FOURTH FLOOR CARPET AREA = 207.13 SQ.MT.
- 6) TOTAL PROPOSED CARPET AREA = 976.05 SQ.MT.

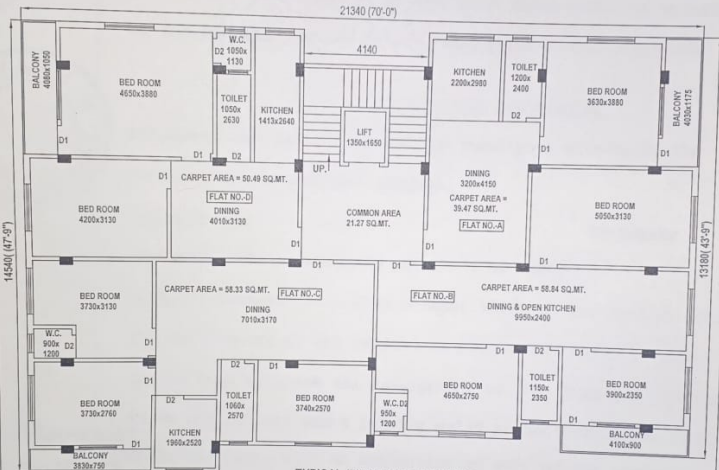

TYPICAL (FIRST TO FOURTH) FLOOR PLAN
 SCALE = 1:100

Sri M. Anand Deb Saha

TECHNOTONIC
 SRI BANDEB SAHA
 Enlisted Planner
 C.M.C Reg. No - 283

SIGNATURE OF DEVELOPER'S :-

SIGNATURE OF LAND OWNER'S :-

SIGNATURE OF ENGINEER